

5.2 Panel Glide System

Technical Information

- | | |
|--|---|
| 1. Cord draw | Moulded U.V. resistant nylon. |
| 2. Track | Extruded aluminium manufactured to ISO9001. |
| 3. Cord fix device | Moulded U.V. resistant nylon. |
| 4. End cap | Moulded from U.V. resistant high density polypropylene. |
| 5. Bracket | Pressed zinc coated steel with spring loaded locking mechanism. |
| 6. Spline cloth holder | Powder coated extruded aluminium manufactured to ISO9001. |
| 7. Lock screw | Zinc coated steel. |
| 8. Cloth holder runner | Moulded from U.V. resistant high density polypropylene. |
| 9. L stop | Moulded U.V. resistant nylon. |
| 10. T stop | Moulded U.V. resistant nylon. |
| 11. Cord control and tensioner or Wand control | Moulded U.V. resistant polycarbonate and nylon. Galvanised spring steel in colour coordinated U.V. resistant plastic cover. |
| 12. Metal bottom weight | Extruded aluminium manufactured to ISO9001. |
| | OPTIONS – BASE RAIL, SEWN IN DOWEL. |

Dimensions & Limitations

	1 Track (2,3,4,5 Channel)
MINIMUM WIDTH	300mm
MAXIMUM WIDTH	5450mm
MAXIMUM DROP	3800mm
MAXIMUM AREA	28m ²
RECOMMENDED PANEL SIZES	Min. 300mm Max. 1100mm

Componentry

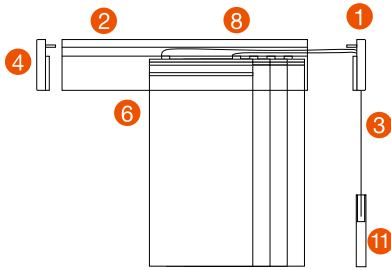

Pelmet + Bracket Allocation

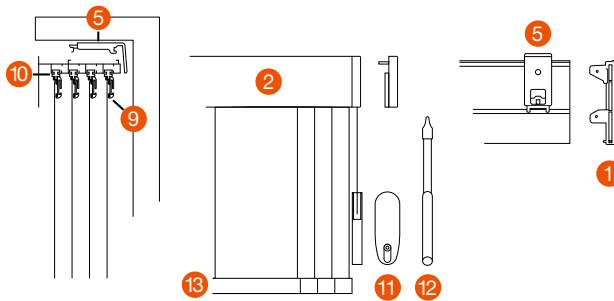

Track Types + Stacking

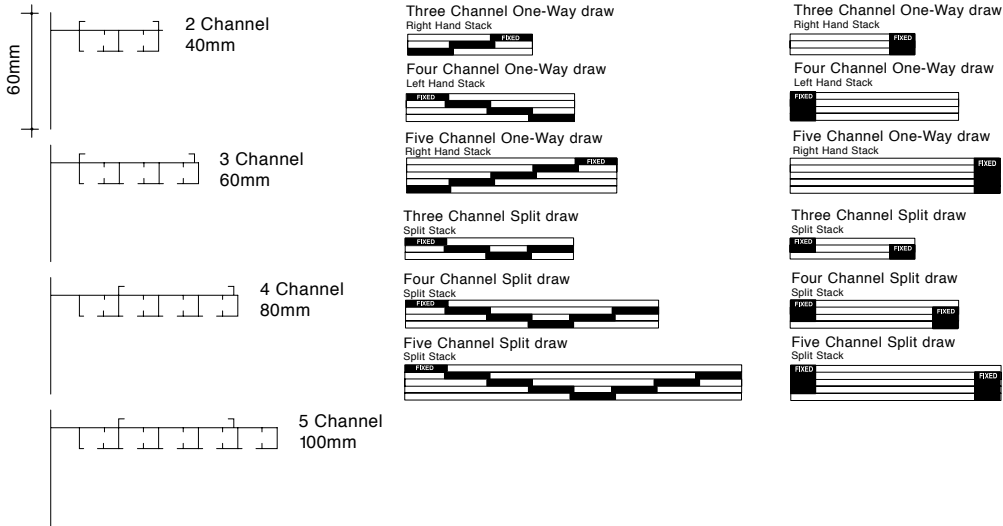

References



No unauthorised reproduction of images, wording and technical drawing without permission from Vertilux. Product specifications may change without notice. The colour image reproduction may vary slightly to actual product. All variations are within industry standards.